

Dolphin Village

4655 Gulf Boulevard | St. Pete Beach, FL 33706

Pinellas County Tampa-St. Petersburg-Clearwater, FL 134,196 Sq Ft

277.223, -82.7393

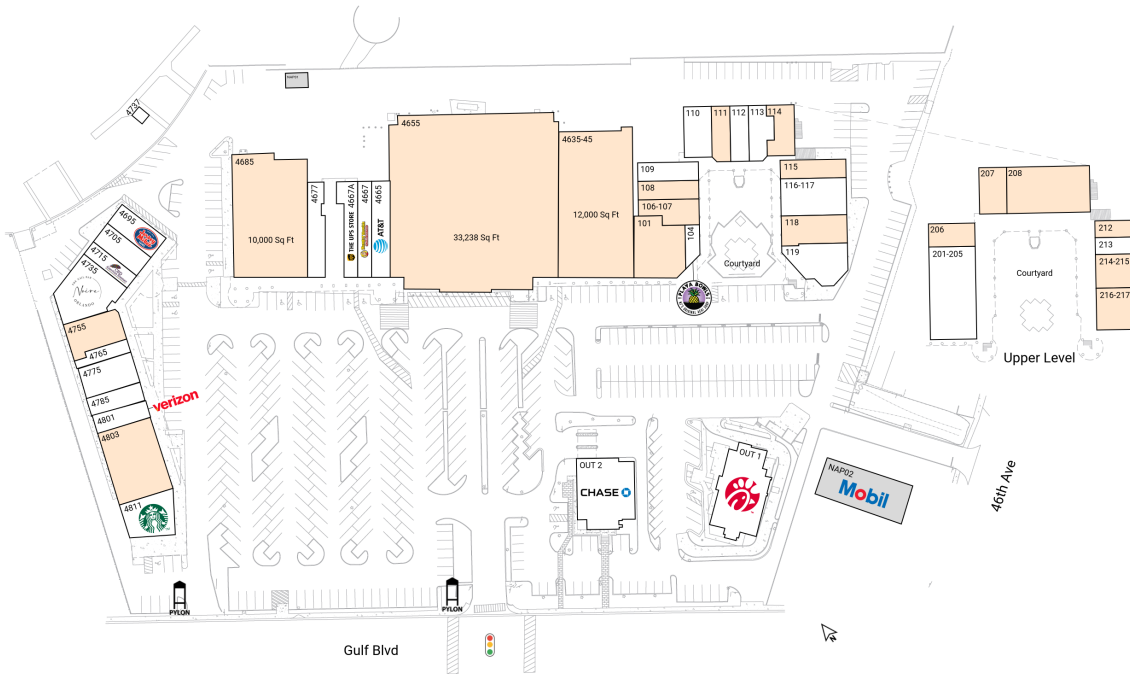

Available Spaces

| | | | | | |
|---------|-------------|------|---------|--------------|------|
| 101 | 2,525 Sq Ft | 360° | 208 | 4,500 Sq Ft | 360° |
| 106-107 | 1,838 Sq Ft | | 212 | 1,000 Sq Ft | |
| 108 | 1,300 Sq Ft | | 214-215 | 2,000 Sq Ft | |
| 111 | 1,188 Sq Ft | | 216-217 | 2,478 Sq Ft | |
| 114 | 1,451 Sq Ft | | 4635-45 | 12,000 Sq Ft | 360° |
| 115 | 1,400 Sq Ft | 360° | 4655 | 33,238 Sq Ft | |
| 118 | 2,000 Sq Ft | | 4685 | 10,000 Sq Ft | |
| 206 | 1,202 Sq Ft | | 4755 | 2,105 Sq Ft | 360° |
| 207 | 1,498 Sq Ft | | 4803 | 4,800 Sq Ft | 360° |

Current Tenants Space size listed in square feet

| | | | | | |
|---------|-----------------------------|-------|------|-------------------------|-------|
| 104 | Playa Bowls | 703 | 4705 | Buona Pizza | 1,500 |
| 109 | Phuong's Jewelry | 1,300 | 4715 | CBD American Shaman | 1,000 |
| 110 | The Fashion Spot | 1,650 | 4735 | Noire the Nail Bar | 3,150 |
| 112 | Alano Beach Club | 1,200 | 4737 | Dolphin Landings | 0 |
| 113 | Beach Vibe Cycle Rentals | 1,387 | 4765 | Beach Zone Ice Cream | 822 |
| 116-117 | Top Shape Gym | 2,800 | 4775 | Dolphin Village Liquors | 2,040 |
| 119 | Shattered Glass Art Studio | 2,536 | 4785 | Indian Bistro | 1,200 |
| 201-205 | Paramount | 5,000 | 4801 | Verizon Wireless | 1,200 |
| 05 | Ballroom | | 4811 | Starbucks | 2,319 |
| 213 | Salon Ancora | 1,000 | OUT | Chick-fil-A | 4,571 |
| 4665 | AT&T | 2,000 | 1 | | |
| 4667 | Hungry Howie's Pizza & Subs | 1,500 | OUT | Chase | 4,195 |
| 4667 | The UPS Store | 1,500 | 2 | | |
| A | | | NAP | Dolphin Landings | 0 |
| 4677 | Swim N Play | 1,600 | 01 | | |
| 4695 | Jersey Mike's | 1,500 | NAP | Mobil | 0 |

This site plan is for illustrative and information purposes only, showing the general layout of the shopping center; and is not a legal survey. Brixmor makes no representation or warranty that the shopping center is exactly as depicted as site conditions and tenant mix are subject to change over time. 1828

